

**DIAMETAL<sup>®</sup>**

*Abrasifs*

Diamant- und CBN-Schleifscheiben  
Meules diamant et CBN  
Diamond and CBN grinding wheels  
Mole diamantate e CBN

Lagerprogramm – Programme stock – Stock program – Programma di stock

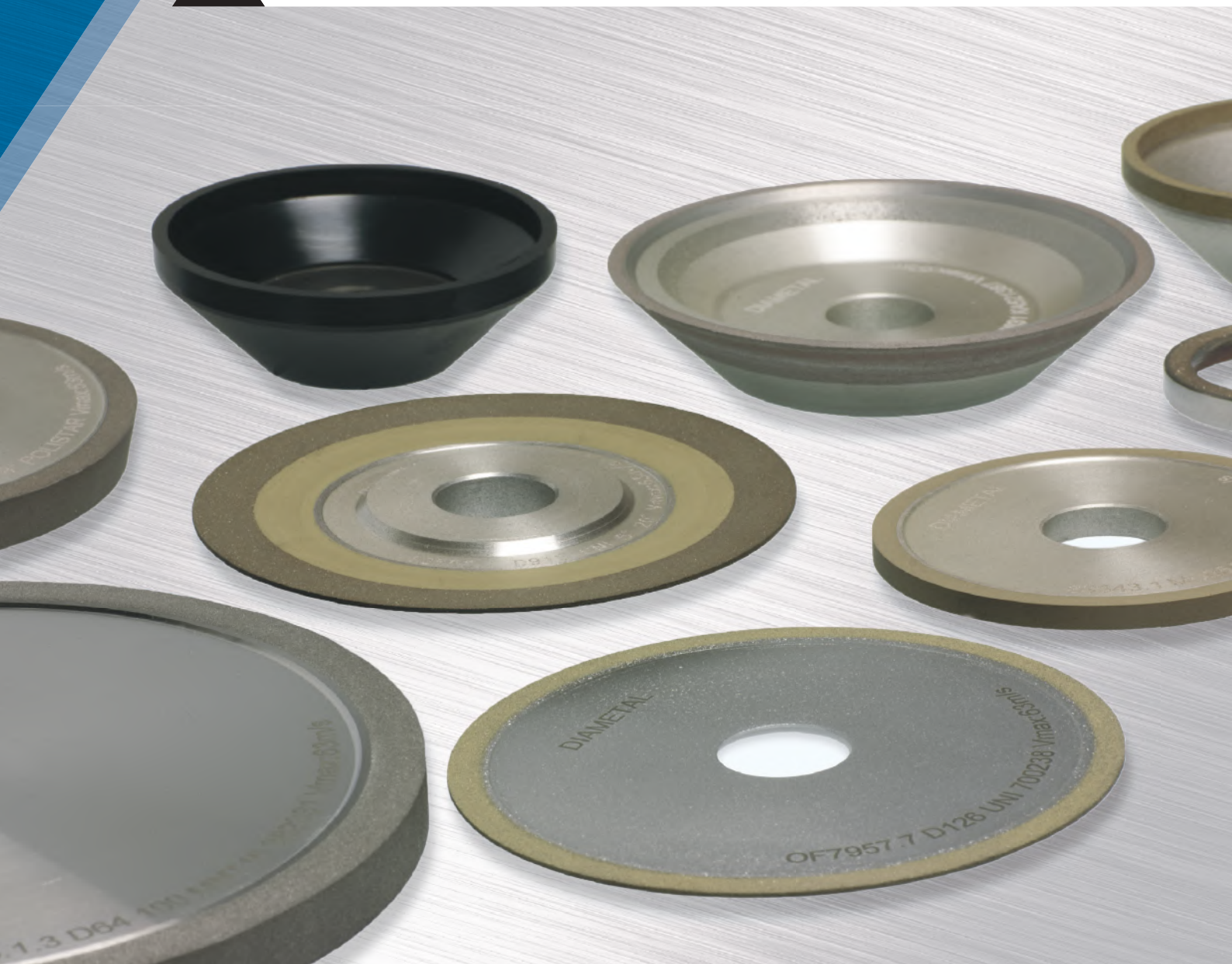

simply **D**ifferent

# Konische Topfscheiben

## Meules boisseaux coniques

### Cup wheels tapered

#### Mole a tazza coniche

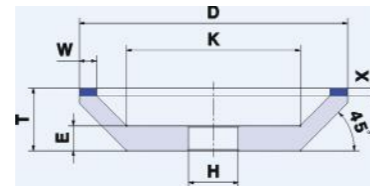

## TYP 12A2

■ Universal ■ Universel ■ Universal ■ Universale

DIA			
721898	12A2 45° Ø75,0 W3,0 D126 C75 B55	H20,00 X4,0 T25,0 E10	
701287	12A2 45° Ø75,0 W3,0 D76 C75 B55	H20,00 X4,0 T25,0 E10	
721899	12A2 45° Ø75,0 W3,0 D54 C75 B55	H20,00 X4,0 T25,0 E10	
701005	12A2 45° Ø75,0 W3,0 MD25 C50 B52	H20,00 X4,0 T25,0 E10	
701015	12A2 45° Ø75,0 W3,0 MD20 C50 B52	H20,00 X4,0 T25,0 E10	
700050	12A2 45° Ø75,0 W3,0 MD16 C50 B1	H20,00 X4,0 T25,0 E10	
703580	12A2 45° Ø75,0 W3,0 MD10 C30 B1	H20,00 X4,0 T25,0 E10	
704229	12A2 45° Ø75,0 W3,0 MD6.3 C30 B160	H20,00 X4,0 T25,0 E10	
707017	12A2 45° Ø100,0 W3,0 D126 C75 B55	H20,00 X4,0 T25,0 E10	
CBN			
706999	12A2 45° Ø75,0 W3,0 B126 180V B55	H20,00 X4,0 T25,0 E10	
707000	12A2 45° Ø75,0 W3,0 B54 180V B55	H20,00 X4,0 T25,0 E10	
716901	12A2 45° Ø75,0 W3,0 MB25 120V B52	H20,00 X4,0 T25,0 E10	

# Konische Topfscheiben

## Meules boisseaux coniques

### Cup wheels tapered

#### Mole a tazza coniche

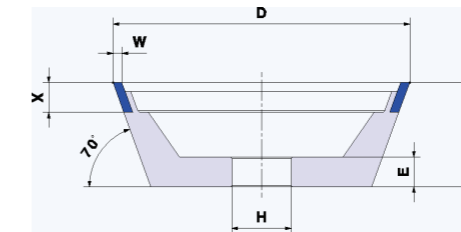

## TYP 11V9

■ Universal ■ Universel ■ Universal ■ Universale

DIA			
701487	11V9 70° Ø75,0 W2,0 D126 C75 B55	H20,00 X10,0 T30,0 E10,0	
701432	11V9 70° Ø75,0 W2,0 D64 C75 B55	H20,00 X10,0 T30,0 E10,0	
704049	11V9 70° Ø75,0 W2,0 MD16 C50 B52	H20,00 X10,0 T30,0 E10,0	
702866	11V9 70° Ø100,0 W3,0 D126 C75 B81	H20,00 X10,0 T35,0 E10,0	
724601	11V9 70° Ø100,0 W2,0 D126 C100 B81	H20,00 X10,0 T35,0 E10,0	
700295	11V9 70° Ø100,0 W2,0 D126 C75 B55	H20,00 X10,0 T35,0 E10,0	
703395	11V9 70° Ø100,0 W2,0 D64 C75 B55	H20,00 X10,0 T35,0 E10,0	
727022	11V9 70° Ø100,0 W2,0 MD16 C50 B52	H20,00 X10,0 T35,0 E10,0	
CBN			
711713	11V9 70° Ø75,0 W2,0 B126 180V B89	H20,00 X10,0 T30,0 E10,0	
713420	11V9 70° Ø100,0 W2,0 B181 180V B89	H20,00 X10,0 T35,0 E10,0	
709210	11V9 70° Ø100,0 W2,0 B126 180V B89	H20,00 X10,0 T35,0 E10,0	

## Konische Topfscheiben

Meules boisseaux coniques

Cup wheels tapered

Mole a tazza coniche

■

### TYP 12V9

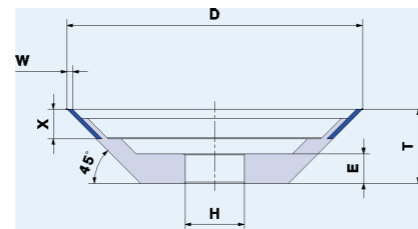

■ Universal ■ Universel ■ Universal ■ Universale

DIA			
706643	12V9 45° Ø75,0 W2,0 D126 C75 B55	H20,00 X6,0 T20,0 E10,0	
701891	12V9 45° Ø75,0 W2,0 D64 C75 B55	H20,00 X6,0 T20,0 E10,0	
703590	12V9 45° Ø75,0 W2,0 MD20 C50 B52	H20,00 X6,0 T20,0 E10,0	
714481	12V9 45° Ø100,0 W2,0 D126 C75 B55	H20,00 X10,0 T25,0 E10,0	
721166	12V9 45° Ø100,0 W2,0 D64 C75 B55	H20,00 X10,0 T25,0 E10,0	
707018	12V9 45° Ø100,0 W2,0 MD20 C50 B52	H20,00 X10,0 T25,0 E10,0	
CBN			
728701	12V9 45° Ø75,0 W2,0 B126 180V B89	H20,00 X6,0 T20,0 E10,0	
724451	12V9 45° Ø100,0 W2,0 B126 180V B89	H20,00 X10,0 T25,0 E10,0	

## Tellerscheiben

Meules assiettes

Plate wheels

Mole a coltello

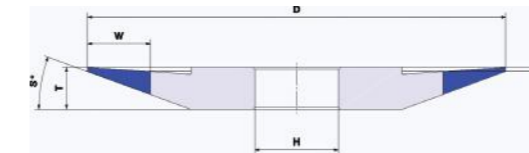

### TYP 4BT9

■ Universal ■ Universel ■ Universal ■ Universale

DIA		
704918	4BT9 Ø60,0 W10,0 D54 C50 B5	H10,00 X0,30 T8,0
706238	4BT9 Ø60,0 W10,0 MD25 C50 B5	H10,00 X0,30 T8,0
701116	4BT9 Ø75,0 W10,0 D91 C75 B5	H10,00 X1,00 T8,0
712569	4BT9 Ø75,0 W10,0 MD25 C75 B5	H10,00 X1,00 T8,0
701736	4BT9 Ø100,0 W10,0 D91 C75 B55	H20,00 X1,00 T10,0
703541	4BT9 Ø100,0 W10,0 MD20 C50 B52	H20,00 X1,00 T10,0
700162	4BT9 Ø125,0 W10,0 D46 C75 B3	H31,75 X0,20 T10,0
705898	4BT9 Ø125,0 W10,0 MD16 C100 B55	H31,75 X0,10 T12,0

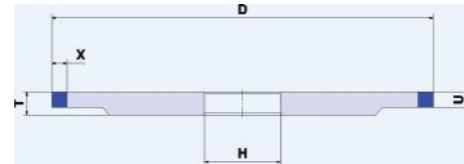

## TYP 4A1

■ Universal ■ Universel ■ Universal ■ Universale

DIA		
728530	4A1 Ø75,0 U4,00 D126 C75 B55	H20,00 X4,0 T6,0
728531	4A1 Ø75,0 U4,00 D54 C75 B55	H20,00 X4,0 T6,0
728532	4A1 Ø75,0 U4,00 MD25 C50 B52	H20,00 X4,0 T6,0
728533	4A1 Ø100,0 U4,00 D126 C75 B55	H20,00 X4,0 T6,0
728534	4A1 Ø100,0 U4,00 D54 C75 B55	H20,00 X4,0 T6,0
728536	4A1 Ø100,0 U4,00 MD25 C50 B52	H20,00 X4,0 T6,0
728704	4A1 Ø300,0 U10,00 D126 C75 B55	H127,00 X5,0 T15,0
CBN		
728545	4A1 Ø75,0 U4,00 B126 180V B55	H20,00 X4,0 T6,0
741927	4A1 Ø75,0 U4,00 B54 180V B52	H20,00 X4,0 T6,0
728546	4A1 Ø100 U4,00 B91 180V B52	H20,00 X4,0 T6,0
728547	4A1 Ø200,0 U10,00 B126 180V B4	H50,00 X4,0 T15,0
746890	4A1 Ø400,0 U10,00 B126 180V B55	H127,00 X5,0 T20,0

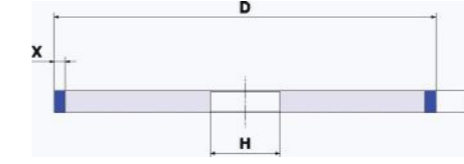

## TYP 1A1

■ Universal ■ Universel ■ Universal ■ Universale

DIA		
700249	1A1 Ø175,0 T10,0 D91 C75 B56	H31,75 X4,0
704872	1A1 Ø175,0 T10,0 D91 C75 B52	H31,75 X4,0
708672	1A1 Ø175,0 T10,0 MD25 C75 B3	H31,75 X4,0
728697	1A1 Ø200,0 T12,0 D126 C75 B55	H50,00 X5,0
728699	1A1 Ø250,0 T12,0 D126 C75 B55	H76,00 X5,0
728705	1A1 Ø300,0 T15,0 D126 C75 B4	H127,00 X5,0
728706	1A1 Ø350,0 T20,0 D126 C75 B4	H127,00 X5,0
728707	1A1 Ø400,0 T20,0 D126 C75 B4	H127,00 X5,0
768592	1A1 Ø400,0 T20,0 D126 C75 B55	H127,00 X5,0
751303	1A1 Ø400,0 T20,0 MD25 C50 B52	H127,00 X5,0
CBN		
746887	1A1 Ø300,0 T10,0 B126 C180 B55	H127,00 X5,0
746888	1A1 Ø300,0 T15,0 B126 180V B55	H127,00 X5,0
746889	1A1 Ø300,0 T20,0 B126 180V B55	H127,00 X5,0
746891	1A1 Ø400,0 T15,0 B126 180V B55	H127,00 X5,0
746892	1A1 Ø400,0 T20,0 B126 180V B55	H127,00 X5,0



## Zweiseitig belegte Topfscheiben

Meules boisseaux double faces

Cup wheels double sided

Mole a tazza a doppia faccia

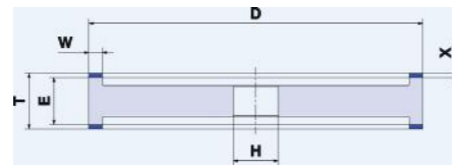

### TYP 9A3

DIA		
200492	9A3 Ø125,0 W5,0 D91 C50 M263/9	H12,00 X2,00 T22,00 E10
702820	9A3 Ø125,0 W5,0 MD16 C50 B1	H12,00 X2,00 T22,00 E10
200494	9A3 Ø150,0 W6,0 D91 C50 M263/9	H16,00 X2,00 T25,00 E14
701102	9A3 Ø150,0 W6,0 MD16 C50 B1	H16,00 X2,00 T25,00 E14
700925	9A3 Ø175,0 W5,0 D126 C75 B55	H20,00 X2,00 T35,00 E14/10
746165	9A3 Ø175,0 W6,0 D91 C75 B55	H20,00 X3,00 T35,00 E14/10
205316	9A3 Ø175,0 W6,0 D91 C50 M263/9	H20,00 X2,50 T35,00 E14/10
200500	9A3 Ø175,0 W6,0 D91 C50 M263/9	H20,00 X2,00 T25,00 E14
704843	9A3 Ø175,0 W5,0 D64 C50 B55	H20,00 X2,00 T35,00 E14/10
703095	9A3 Ø175,0 W6,0 MD20 C40 B52	H20,00 X2,00 T35,00 E14/10
707185	9A3 Ø175,0 W6,0 MD16 C50 B1	H20,00 X2,00 T35,00 E14/10
700009	9A3 Ø175,0 W6,0 MD16 C50 B1	H20,00 X2,00 T25,00 E14

## Trennscheiben

Disques à tronçonner

Slitting discs

Dischi da taglio

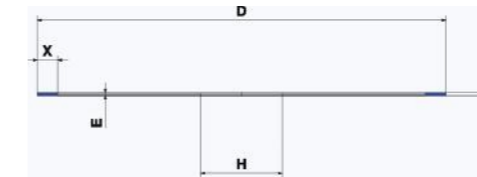

### TYP 1A8R

DIA		
708330	1A8R Ø50,0 T0,40 D126 C100 B55	H10,00 X5,0 E0,3

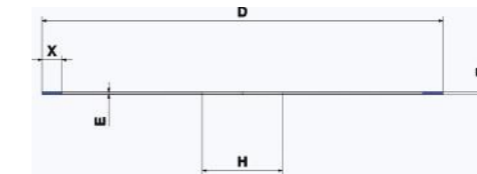

### TYP 1A1R

DIA		
703030	1A1R Ø75,0 T0,80 D126 C100 B55	H20,00 X5,0 E0,5
700237	1A1R Ø75,0 T0,80 D126 C100 B55	H10,00 X5,0 E0,5
700238	1A1R Ø100,0 T0,80 D126 C100 B55	H20,00 X5,0 E0,5
701657	1A1R Ø100,0 T0,80 D126 C100 B55	H10,00 X5,0 E0,5
700714	1A1R Ø125,0 T1,10 D126 C100 B55	H31,75 X5,0 E0,8
700486	1A1R Ø125,0 T1,10 D126 C100 B55	H20,00 X5,0 E0,8
701263	1A1R Ø150,0 T1,20 D126 C100 B55	H31,75 X5,0 E0,9
700487	1A1R Ø150,0 T1,20 D126 C100 B55	H20,00 X5,0 E0,9
705365	1A1R Ø175,0 T1,20 D126 C100 B55	H51,00 X5,0 E1,0
722258	1A1R Ø200,0 T1,20 D126 C100 B55	H30,00 X7,0 E0,9

CBN		
706245	1A1R Ø75,0 T0,80 B151 240V B55	H20,00 X5,0 E0,5
706244	1A1R Ø75,0 T0,80 B151 240V B55	H10,00 X5,0 E0,5
706247	1A1R Ø100,0 T0,80 B151 240V B55	H20,00 X5,0 E0,5
706246	1A1R Ø100,0 T0,80 B151 240V B55	H10,00 X5,0 E0,5
707187	1A1R Ø125,0 T1,10 B151 240V B55	H20,00 X5,0 E0,8
710866	1A1R Ø150,0 T1,20 B151 240V B55	H20,00 X5,0 E0,9
722259	1A1R Ø200,0 T1,20 B151 180V B55	H30,00 X7,0 E0,9

## Peripheriescheiben CNC

## Meules périphériques CNC

## Periphery wheels CNC

## Mole periferiche CNC

### TYP 1A1 / 1A1S / 1V1 / 1B1

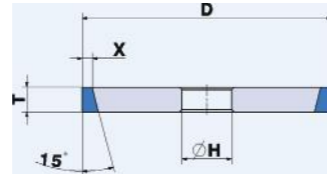

■ Spezial ■ Spécial ■ Special ■ Speciale

DIA		
759989	1A1S Ø75,0 T10,0 D64 MNTPlus	H20,00 X10
397400	1A1 Ø75,0 T10,0 D64 MNT9	H20,00 X10
759988	1A1S Ø100,0 T8,0 D64 MNTPlus	H20,00 X10
397404	1A1 Ø100,0 T8,0 D64 MNT9	H20,00 X10
759987	1A1S Ø100,0 T10,0 D64 MNTPlus	H20,00 X10
397408	1A1 Ø100,0 T10,0 D64 MNT9	H20,00 X10
759986	1A1S Ø100,0 T12,0 D64 MNTPlus	H20,00 X10
397402	1A1 Ø100,0 T12,0 D64 MNT9	H20,00 X10
387154	1V1 75° Ø100,0 T12,0 D64 MNT9	H20,00 X8
761898	1A1 Ø100,0 T15,0 D64 MNTplus	H20,00 X8
397209	1A1 Ø100,0 T16,0 D64 MNT9	H20,00 X10
759985	1A1S Ø125,0 T10,0 D64 MNTPlus	H20,00 X10
397405	1A1 Ø125,0 T10,0 D64 MNT9	H20,00 X10
759982	1A1S Ø125,0 T12,0 D64 MNTPlus	H20,00 X10
397406	1A1 Ø125,0 T12,0 D64 MNT9	H20,00 X10
760024	1A1 Ø125,0 T15,0 D64 MNTplus	H20,00 X8
397280	1A1 Ø125,0 T16,0 D64 MNT9	H20,00 X8
759966	1A1S Ø150,0 T10,0 D64 MNTPlus	H20,00 X10
397407	1A1 Ø150,0 T10,0 D64 MNT9	H20,00 X10
398001	1A1 Ø150,0 T15,0 D64 MNT9	H20,00 X10
746885	1B1 45° Ø100,0 T8,0 D64 ALPHASTAR	H20,00 X12
758175	1A1 Ø100,0 T8,0 D64 C100 B313	H20,00 X8
736682	1A1S Ø100,0 T10,0 D64 C100 B836	H20,00 X5/8
746883	1A1 Ø100,0 T16,0 D64 C100 B836	H20,00 X8
736681	1A1S Ø125,0 T12,0 D64 C100 B836	H20,00 X5/8
746886	1V1 45° Ø125,0 T15,0 D64 C100 B836	H20,00 X8
748523	1A1 Ø75,0 T8,0 POLISTAR	H20,00 X5
744513	1A1 Ø100,0 T10,0 POLISTAR	H20,00 X5
CBN		
728551	1A1S Ø75,0 T8,0 B91 200V B88	H20,00 X5/8
724115	1A1S Ø100,0 T10,0 B91S 200V B88	H20,00 X5/8
724118	1A1S Ø125,0 T12,0 B91S 200V B88	H20,00 X5/8

## Konische Topfscheiben CNC

## Meules boisseaux coniques CNC

## Cup wheels tapered CNC

## Mole a tazza coniche CNC

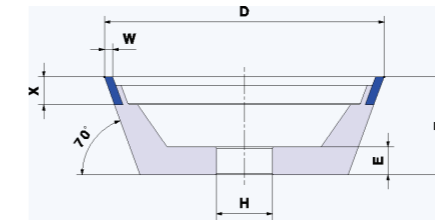

### TYP 11V9

DIA		
733790	11V9 70° Ø75,0 W2,0 D64 ALPHASTAR	H20,00 X10,0 T35,0 E10,0
733254	11V9 70° Ø75,0 W2,0 D64 C100 B313	H20,00 X10,0 T30,0 E10,0
746516	11V9 70° Ø75,0 W3,0 D46 C100 B813	H20,00 X10,0 T30,0 E10,0
744350	11V9 70° Ø100,0 W3,0 D64 ALPHASTAR	H20,00 X10,0 T35,0 E10,0
745455	11V9 70° Ø100,0 W3,0 D64 C100 SPB198	H20,00 X10,0 T35,0 E10,0
732649	11V9 70° Ø100,0 W2,0 D64 C100 B313	H20,00 X10,0 T35,0 E10,0
746522	11V9 70° Ø100,0 W3,0 D46 C100 B813	H20,00 X10,0 T35,0 E10,0
CBN		
713417	11V9 70° Ø75,0 W2,0 B126 240V B88	H20,00 X10,0 T30,0 E10,0
711948	11V9 70° Ø100,0 W2,0 B126 240V B88	H20,00 X10,0 T35,0 E10,0
713438	11V9 70° Ø100,0 W2,0 B76 240V B88	H20,00 X10,0 T35,0 E10,0
729024	11V9 70° Ø125,0 W3,0 B126 240V B88	H20,00 X10,0 T40,0 E10,0

## Konische Topfscheiben CNC

Meules boisseaux coniques CNC

Cup wheels tapered CNC

Mole a tazza coniche CNC

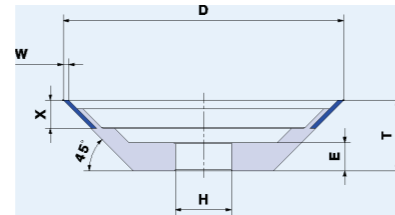

### TYP 12V9

DIA			
733256	12V9 45° Ø100,0 W2,0 D64 ALPHASTAR	H20,00 X10,0 T25,0 E10,0	
764009	12V9 45° Ø100,0 W3,0 D64 ALPHASTAR	H20,00 X10,0 T25,0 E10,0	
760230	12V9 45° Ø100,0 W3,0 D64 C100 SPB198	H20,00 X10,0 T20,0 E10,0	
764010	12V9 45° Ø100,0 W3,0 D46 C100 B813	H20,00 X10,0 T25,0 E10,0	
733257	12V9 45° Ø125,0 W3,0 D64 C100 B313	H20,00 X10,0 T25,0 E10,0	
749325	12V9 45° Ø125,0 W3,0 D64 ALPHASTAR	H20,00 X10,0 T25,0 E10,0	
746524	12V9 45° Ø125,0 W3,0 D46 C100 B813	H20,00 X10,0 T25,0 E10,0	
CBN			
724625	12V9 45° Ø100,0 W2,0 B126 240V B88	H20,00 X10,0 T20,0 E10,0	
724626	12V9 45° Ø125,0 W3,0 B126 240V B88	H20,00 X10,0 T25,0 E10,0	

## Tellerscheiben CNC

Meules assiettes CNC

Plate wheels CNC

Mole a coltello CNC

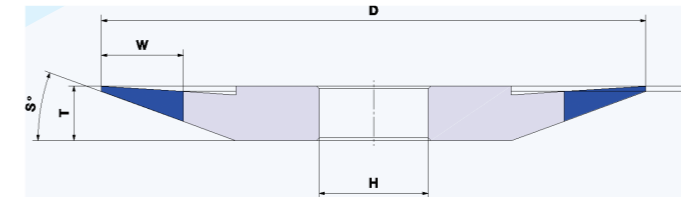

### TYP 4BT9

DIA		
718005	4BT9 Ø100,0 W10,0 D91S C100 B56	H20,00 X1,00 T10,0
CBN		
716828	4BT9 Ø100,0 W10,0 B126 240V B88	H20,00 X1,00 T10,0

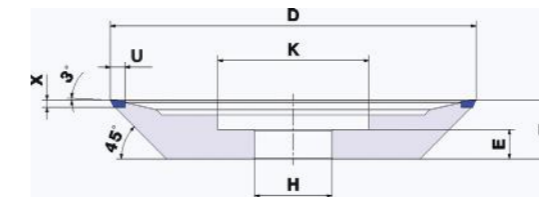

### TYP 4B1

DIA		
236465	4B1 65,0° Ø150,0 U3,0 MD10 C100 VCR	H31,75 X6,00 T24,0

## Zylindrische Topfscheiben

Meules boisseaux cylindriques

Cup wheels straight

Mole a tazza dritte

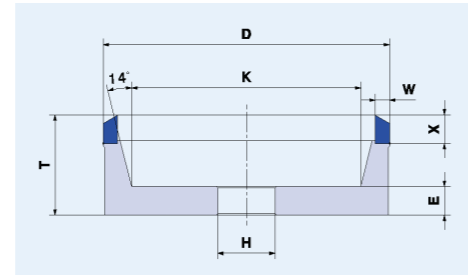

### TYP 6M9

735613 6M9 30° Ø100,0 W5,0 D64 C100 B313 H20,00 X10,0 T35,0 €  
EUR 250

## Abrichtring

Bagues de dressage

Dressing ring

Anelli ravvivatori

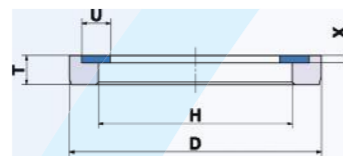

### TYP 2A7

DIA		
303869	2A7 Ø44,0 U3,50 D107 C100 M263	H37,00 X0,8 T5,0
303908	2A7 Ø52,0 U4,00 D181 C100 M263	H45,00 X0,8 T6,0
303883	2A7 Ø52,0 U4,00 D151 C100 M263	H45,00 X0,8 T6,0
351455	2A7 Ø52,0 U4,00 D151 C100 M263/4	H45,00 X0,8 T6,0
303880	2A7 Ø52,0 U4,00 D107 C100 M263	H45,00 X0,8 T6,0
374124	2A7 Ø58,0 U3,00 D151 C100 M263/4	H53,00 X0,8 T6,0
303878	2A7 Ø70,0 U4,00 D181 C100 M263	H63,00 X0,8 T6,0
303877	2A7 Ø70,0 U4,00 D151 C100 M263	H63,00 X0,8 T6,0
303876	2A7 Ø70,0 U4,00 D107 C100 M263	H63,00 X0,8 T6,0
369009	2A7 Ø92,0 U4,00 D151 C100 M263	H85,00 X0,8 T6,0

## Reduktionshülsen

Bagues de réduction

Bore hole reducers

Anelli di riduzione

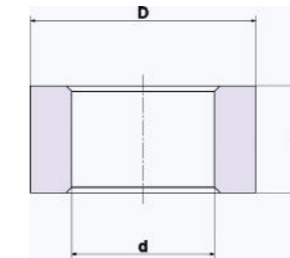

224923	D Ø: 20; d Ø: 10; B 9,5
224924	D Ø: 20; d Ø: 10; B 5,5
224926	D Ø: 20; d Ø: 12,7; B 5,5
224928	D Ø: 20; d Ø: 13; B 5,5
224925	D Ø: 20; d Ø: 12,7; B 9,5
224927	D Ø: 20; d Ø: 13; B 9,5
224929	D Ø: 20; d Ø: 14; B 9,5
224930	D Ø: 20; d Ø: 14; B 5,5
224931	D Ø: 20; d Ø: 15; B 9,5
224932	D Ø: 20; d Ø: 15; B 5,5
224933	D Ø: 32; d Ø: 20; B 9,5
224934	D Ø: 32; d Ø: 20; B 5,5



## Schärfsteine

Pierres d'avivages

Sharpening stones

Pietre per affilare

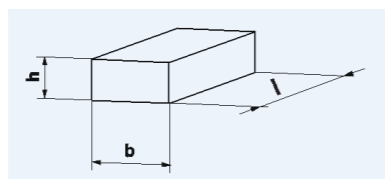

### SST1 D46 - D301

206226	l: 100 b: 25 h: 12	rot / rouge / red / rosso
236105	l: 200 b: 50 h: 25	rot / rouge / red / rosso

### SST2 MD1,3 - MD40

206227	l: 100 b: 22 h: 12	weiss / blanche / white / bianco
236106	l: 135 b: 50 h: 25	weiss / blanche / white / bianco

### SST3 Spez.

215547	l: 80 b: 21 h: 13	grau / grise / grey / grigio
210460	l: 80 b: 25 h: 13	grau / grise / grey / grigio

## SIC-Abrichtscheiben

Meules de dressage

Dressing wheels

Mole di ravnivatura

306907	SIC 75x13H11x20 1 500
306906	SIC 75x13H11x20 1 320
306905	SIC 75x13H11x20 1 240
306904	SIC 100x20H11x20 1 500
306903	SIC 100x20H11x20 1 320
306902	SIC 100x20H11x20 1 240
427319	SIC 100x20H11x20 1 120
810114	SIC 100x20H11x10 1 60

## Diamantpasten

Pâtes diamantées

Diamond polishing pastes

Paste diamantate

### C50

Korngrösse Grosueur de grain Grit size Granulometria	Farbe Couleur Color Colore	Konzentration Concentration Concentration Concentrazione	5 g	10 g
FEPA	μ			
D46	40 – 60	orange / orange / orange / arancione	205152	206938
MD40	30 – 45	dunkelbraun / brun foncé / dark brown / marrone scuro	205151	206936
MD25	20 – 40	violett / violette / violet / viola	202615	206934
MD20	20 – 30	weiss / blanche / white / bianco	202616	206932
MD16	12 – 22	dunkelblau / bleu foncé / dark blue / blu scuro	205150	202619
MD14	10 – 16	ocker / ocre / ochre / ocre	205149	202620
MD10	6 – 12	rot / rouge / red / rosso	205148	202621
MD6.3	4 – 8	gelb / jaune / yellow / giallo	205147	202622
MD4	3 – 6	rosa / rose / pink / rosa	205146	206928
MD2.5	1 – 5	grün / verte / green / verde	205145	206929
MD1.8	0,5 – 3	silber / argent / silver / argento	202617	206925
MD1	0,5 – 2	hellblau / bleu clair / light blue / blu chiaro	205144	202623
MD0.5	0,5 – 1	hellblau / bleu clair / light blue / blu chiaro	205143	206923

### C100

Korngrösse Grosueur de grain Grit size Granulometria	Farbe Couleur Color Colore	Konzentration Concentration Concentration Concentrazione	5 g	10 g
FEPA	μ			
D46	40 – 60	orange / orange / orange / arancione	205160	206937
MD40	30 – 45	dunkelbraun / brun foncé / dark brown / marrone scuro	205159	206935
MD25	20 – 40	violett / violette / violet / viola	202628	206933
MD20	20 – 30	weiss / blanche / white / bianco	202629	206931
MD16	12 – 22	dunkelblau / bleu foncé / dark blue / blu scuro	205158	202631
MD14	10 – 16	ocker / ocre / ochre / ocre	205157	202632
MD10	6 – 12	rot / rouge / red / rosso	205156	202633
MD6.3	4 – 8	gelb / jaune / yellow / giallo	205155	202634
MD4	3 – 6	rosa / rose / pink / rosa	205154	206927
MD2.5	1 – 5	grün / verte / green / verde	205153	206930
MD1.8	0,5 – 3	silber / argent / silver / argento	202630	206924



# DIAMETAL®

Group 

Solothurnstrasse 136  
CH 2504 Biel/Bienne

Tel +41 32 344 33 33  
Fax +41 32 344 33 44  
sales@diametal.com

# DIAMETAL®

Switzerland 

Solothurnstrasse 136  
CH 2504 Biel/Bienne

Tel +41 32 344 33 33  
Fax +41 32 344 33 44  
sales@diametal.com

# DIAMETAL®

France 

Route de Wolschwiller  
FR 68480 Oltingue

Tel +33 3 89 07 58 00  
Fax +33 3 89 40 70 41  
sales-fr@diametal.com

# DIAMETAL®

Italy 

Via G. Rossini 10  
IT 21052 Busto Arsizio (VA)

Tel +39 331 62 94 78  
Fax +39 331 62 97 20  
sales-it@diametal.com

# DIAMETAL®

China 

Precision Tooling (Nanjing) Ltd.  
No. 70, Phoenix Road  
Room 210, Building 43  
Jiangning Development Zone  
CN 211106 Nanjing

Tel +86 25 5210 6910  
Fax +86 25 5210 6912  
sales-cn@diametal.com

[www.diametal.com](http://www.diametal.com)

Suivez-nous sur

